

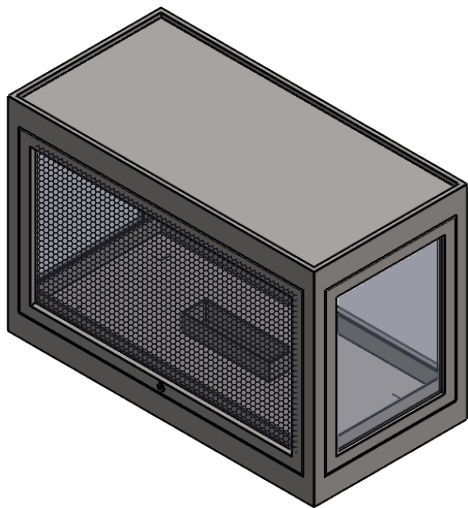

COLOR, DIMENSION, AND DESIGN MAY VARY BASED ON CUSTOMIZATION



SPECIFICATIONS & DIMENSIONS:

- Fireboxes Are To Be Secured To Base By Contractor With Four Screws In Holes Provided. No Other Attachments To The Firebox Are Permitted.
 - Do Not Puncture The Firebox.
 - No Weight Is To Be Put On The Firebox. Millwork Or Wall Above Must Be Self Supporting And May Not Rest On The Firebox
 - All Wall Treatments By Others.
 - Fire Rated Assemblies Of Partitions And Any Openings On Partitions Are The Responsibility Of Others.
 - The Base Is To Be Supplied By Others And Must Support At Least 40lbs. per Square Foot.
 - There Must be 1/8" Clearance On The Top and Sides Of The Firebox When Installed.
1. No Wood, Laminates, Or Heat Sensitive Materials May Occur Above The Face Of The Firebox For The First 6" Above The Firebox
 2. Millwork Commencing 12" Above The Firebox May Protrude Past The Face Of The Firebox At A 45 Degree Angle
 3. 12" Minimum Clearance To Nearest Electronic Device Or As Specified By Product Manufacturer
 4. A Non Heat Sensitive Ledge (By Others) Must Protrude A Min. Of 3" Past The Face Of Electronic Device For Heat Deflection Above Firebox And Below Electronic Device

